

BENCHMARKS			
NO.	LOCATION	DESCRIPTION	ELEV.
1	9+88, 13' RT.	TOP OF S.W. WINGWALL	1357.87
2	7+75, 53' RT.	TOP OF BOULDER	1358.05

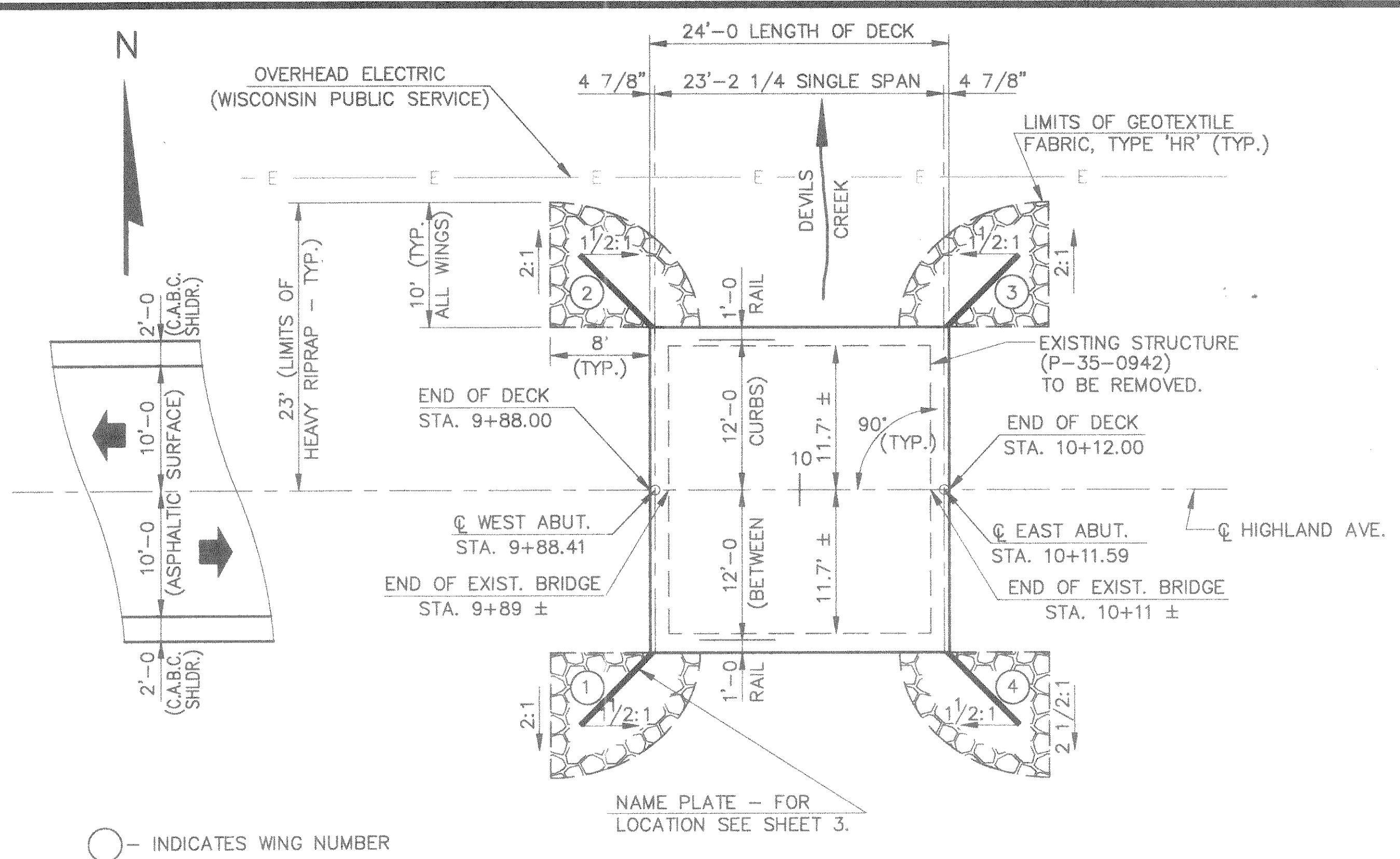

PLAN (SINGLE SPAN TIMBER SLAB)

○ INDICATES WING NUMBER

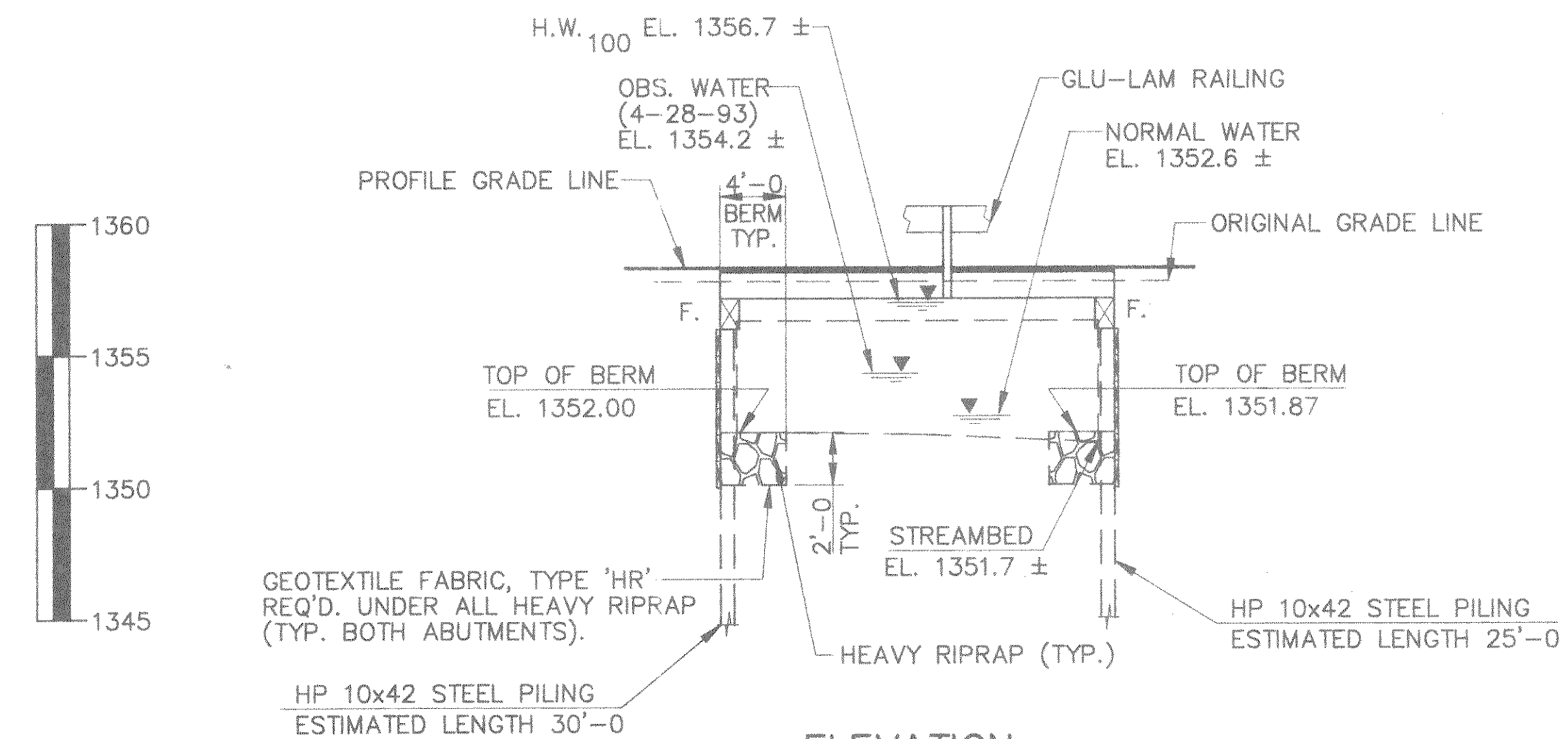

ELEVATION (NORMAL TO DEVILS CREEK)

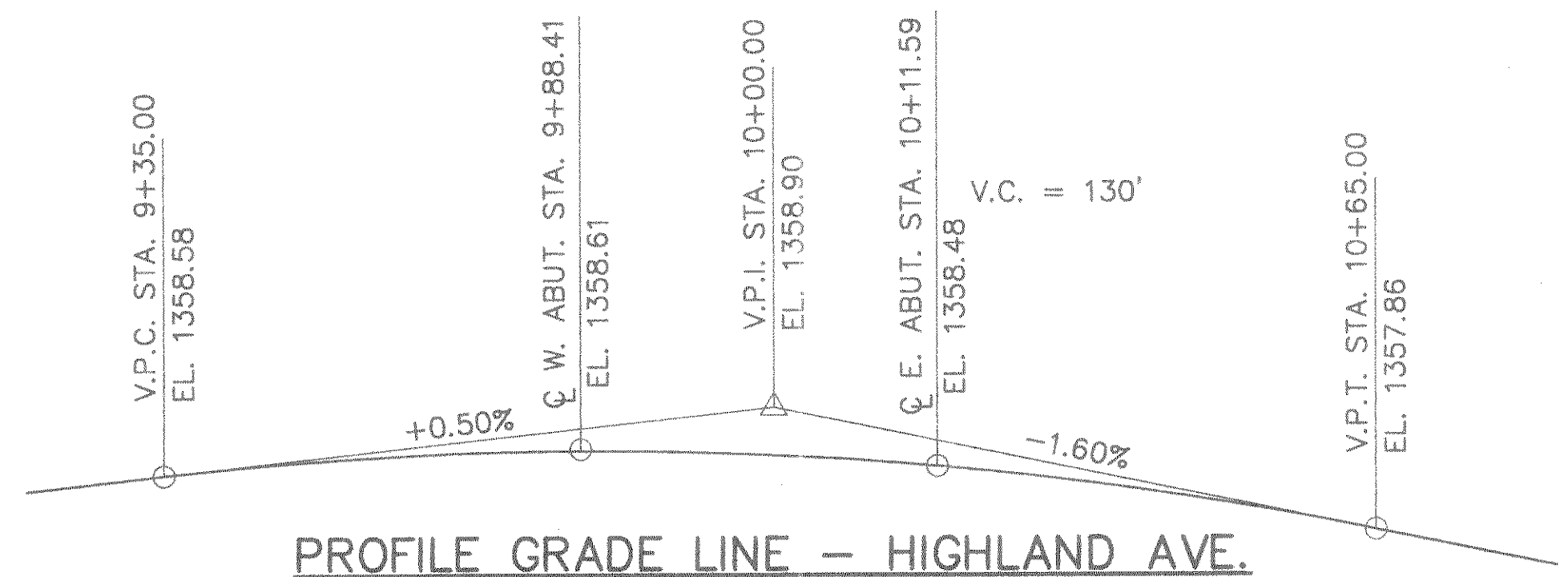

GENERAL NOTES

DRAWINGS SHALL NOT BE SCALED.  
 CONSTRUCTION REQUIREMENTS SHALL CONFORM TO SECTION 507.  
 ALL TIMBER IS TO BE CREOSOTE OR PENTACHLOROPHENOL TREATED PER SECTION 507.  
 ALL HARDWARE TO BE GALVANIZED PER SECTION 507.  
 ALL TIMBER IS ROUGH CUT UNLESS OTHERWISE NOTED.  
 TIMBER CONNECTORS AND HARDWARE SHALL BE INCLUDED IN THE BID ITEM "TREATED LUMBER AND TIMBER".  
 DESTROY THREADS ON ALL BOLTS WITH A CENTER PUNCH AFTER TIGHTENING NUT.  
 BOLT PROJECTIONS EXCEEDING 1" SHALL BE CUT OFF. REPAIR END OF BOLT BY PAINTING WITH ZINC RICH PRIMER.  
 GLU-LAM RAILING & TIMBER DECK PANELS TO BE INCLUDED IN THE BID ITEM, "TREATED LUMBER AND TIMBER".  
 THE SLOPE OF THE FILL IN FRONT OF THE ABUTMENTS SHALL BE COVERED WITH HEAVY RIPRAP AND GEOTEXTILE FABRIC TO THE EXTENT SHOWN ON THIS SHEET AND IN THE ABUTMENT DETAILS.  
 THIS STRUCTURE WILL REPLACE EXISTING BRIDGE P-35-0942, A 22.6 FT. LONG SINGLE SPAN, 23.3 FT. CLEAR ROADWAY WIDTH, STEEL DECK GIRDER SET ON FULL RETAINING CONCRETE ABUTMENTS.  
 THE EXISTING GROUNDLINE SHALL BE THE UPPER LIMITS OF "EXCAVATION FOR STRUCTURES" FOR THE ABUTMENTS.  
 AT THE ABUTMENTS ALL EXCAVATED VOLUME NOT OCCUPIED BY THE NEW STRUCTURE SHALL BE BACKFILLED WITH GRANULAR BACKFILL. PAYMENT WILL BE INCLUDED IN THE BID ITEM "EXCAVATION FOR STRUCTURES, BRIDGES B-35-131".  
 DEWATERING IF NECESSARY TO ATTACH THE BOTTOM TIMBER BACKING PLANKS FOR THE ABUTMENTS SHALL BE INCLUDED IN THE BID ITEM "EXCAVATION FOR STRUCTURES, BRIDGES B-35-131".  
 PILES AND STEEL PLATES SHALL BE PAINTED PER SUPPLEMENTAL SPECIFICATIONS 511.3.5.  
 SUPERSTRUCTURE SHALL BE IN PLACE BEFORE ABUTMENTS ARE BACKFILLED ABOVE THE BERM ELEVATIONS. BACKFILL SIMULTANEOUSLY TO AVOID RACKING OF SUPERSTRUCTURE.

GENERAL NOTE FOR FUTURE MAINTENANCE

WHEN PLACING FUTURE WEARING SURFACE OVERLAY ON TOP OF ASPHALTIC SURFACE SHOWN ON THIS PLAN, THE THICKNESS OF THE OVERLAY MUST BE TAPERED NEAR THE VICINITY OF THE RAILING TO MAINTAIN THE REQUIRED (CRASH TESTED) DISTANCE OF 32 INCHES FROM TOP OF WEARING SURFACE TO TOP OF RAIL.

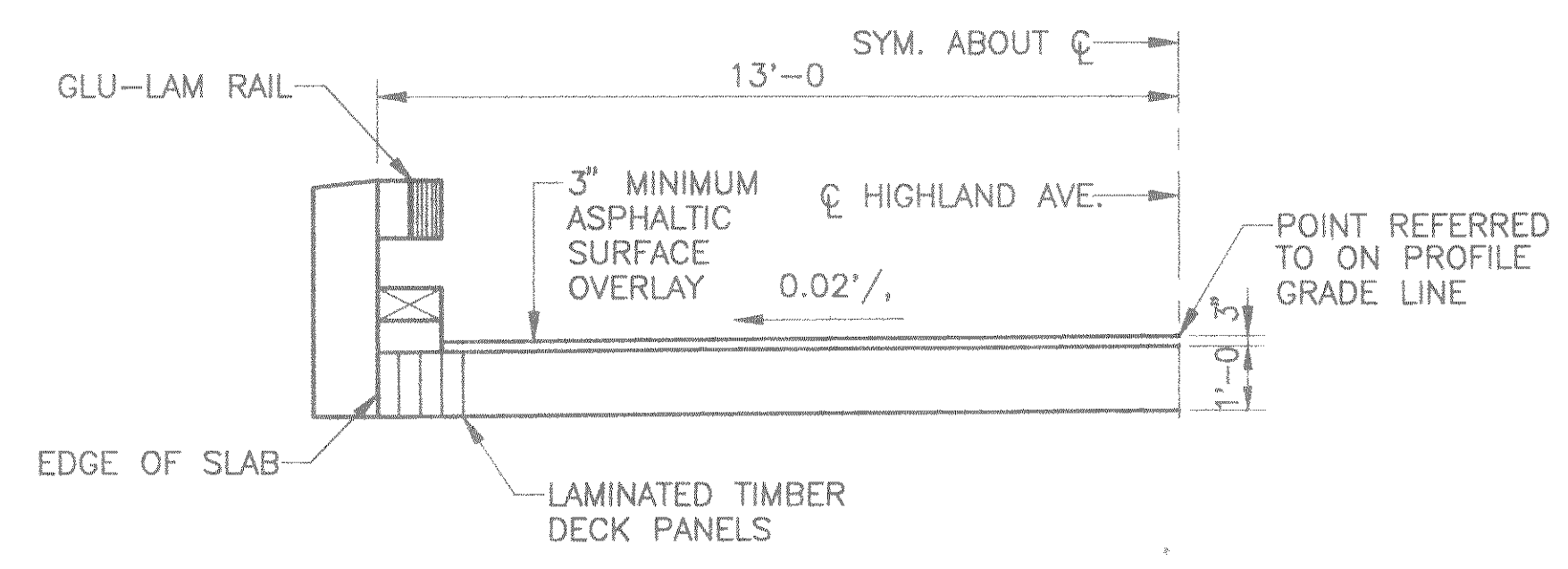

HALF-CROSS SECTION THRU ROADWAY

TOTAL ESTIMATED QUANTITIES

BID ITEMS	UNIT	WEST ABUT.	EAST ABUT.	SUPER	TOTAL
REMOVING OLD BRIDGE, STATION 10+00	L.S.	---	---	---	1
EXCAVATION FOR STRUCTURES, BRIDGES B-35-131	L.S.	---	---	---	1
STRUCTURAL CARBON STEEL	LB.	160	160	---	320
TREATED LUMBER AND TIMBER	MBM	1.8	1.8	8.9	12.5
STEEL PILING DELIVERED & DRIVEN HP 10 INCH, 42 POUND	L.F.	210	175	---	385
HEAVY RIPRAP	C.Y.	25	25	---	50
GEOTEXTILE FABRIC, TYPE DF	S.Y.	35	35	---	70
GEOTEXTILE FABRIC, TYPE HR	S.Y.	50	50	---	100

DESIGN DATA

LIVELOAD: DESIGN RATING : HS-20  
 INVENTORY RATING : HS-25  
 OPERATING RATING : HS-35  
 STRUCTURE IS DESIGNED FOR A FUTURE WEARING SURFACE OF 20 POUNDS PER SQUARE FOOT.  
 MAX. STD. PERMIT VEHICLE LOAD = 180 KIPS

TRAFFIC DATA:  
 A.D.T. (1995) = 20  
 A.D.T. (2015) = 30

ALLOWABLE DESIGN STRESSES:

TIMBER RAIL POSTS (NO HEARTWOOD ALLOWED) fb = 1,900 P.S.I.  
 GLU-LAM RAILING (DRY CONDITION) fb = 2,400 P.S.I.  
 FLOOR PLANKS FOR PREFAB PANELS fb = 1,500 P.S.I.  
 ALL OTHER TIMBER fb = 1,300 P.S.I.

FOUNDATION DATA:

ABUTMENTS SHALL BE SUPPORTED ON HP 10x42 STEEL PILING DRIVEN TO SOUND ROCK WITH A MINIMUM BEARING VALUE OF 40 TONS PER PILE. ESTIMATED PILE LENGTHS ARE 30'-0" AT THE WEST ABUTMENT AND 25'-0" AT THE EAST ABUTMENT.

HYDRAULIC DATA:

100 YEAR FREQUENCY	
DRAINAGE AREA	5.36 SQ. MI.
Q <sub>100</sub>	510 C.F.S.
VELOCITY	8.1 F.P.S.
WATERWAY AREA	63 SQ. FT.
HIGH WATER <sub>100</sub> ELEVATION	1356.7 ±
ROADWAY OVERFLOW DESIGN FREQUENCY	N/A
SCOUR CRITICAL CODE	8

LIST OF DRAWINGS

- GENERAL PLAN
- SUBSURFACE EXPLORATION
- ABUTMENTS
- ABUTMENT DETAILS
- SUPERSTRUCTURE
- SUPERSTRUCTURE DETAILS

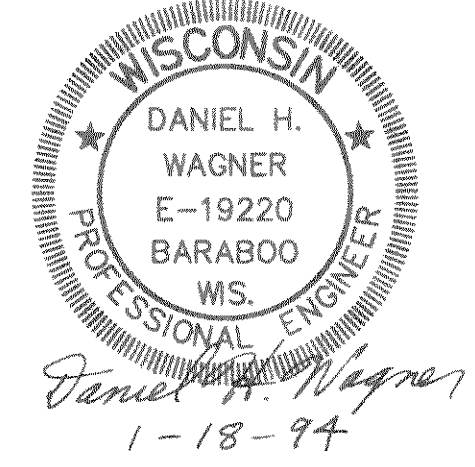

BRIDGE OFFICE CONTACT: (608) 264-9425

No.	Date	Revision	By
PLANS PREPARED BY			
MID-STATE ASSOCIATES, INC. 1230 S. BLVD., BARABOO, WI. 53913			
STATE OF WISCONSIN DEPARTMENT OF TRANSPORTATION DIVISION OF HIGHWAYS			
STRUCTURE B-35-131			
HIGHLAND AVENUE OVER DEVILS CREEK			
County	LINCOLN	Town/City/Village	CORNING
Design Spec.	AASHTO 1992	Load	HS-20
Design By	DHW	Design Checked	RJR
Drawn By	RLR	Plans Checked	DHW
Approved _____		State Bridge Engineer Date _____	
GENERAL PLAN			SHEET 1 OF 6