

PLAN OF BODY & WINGS

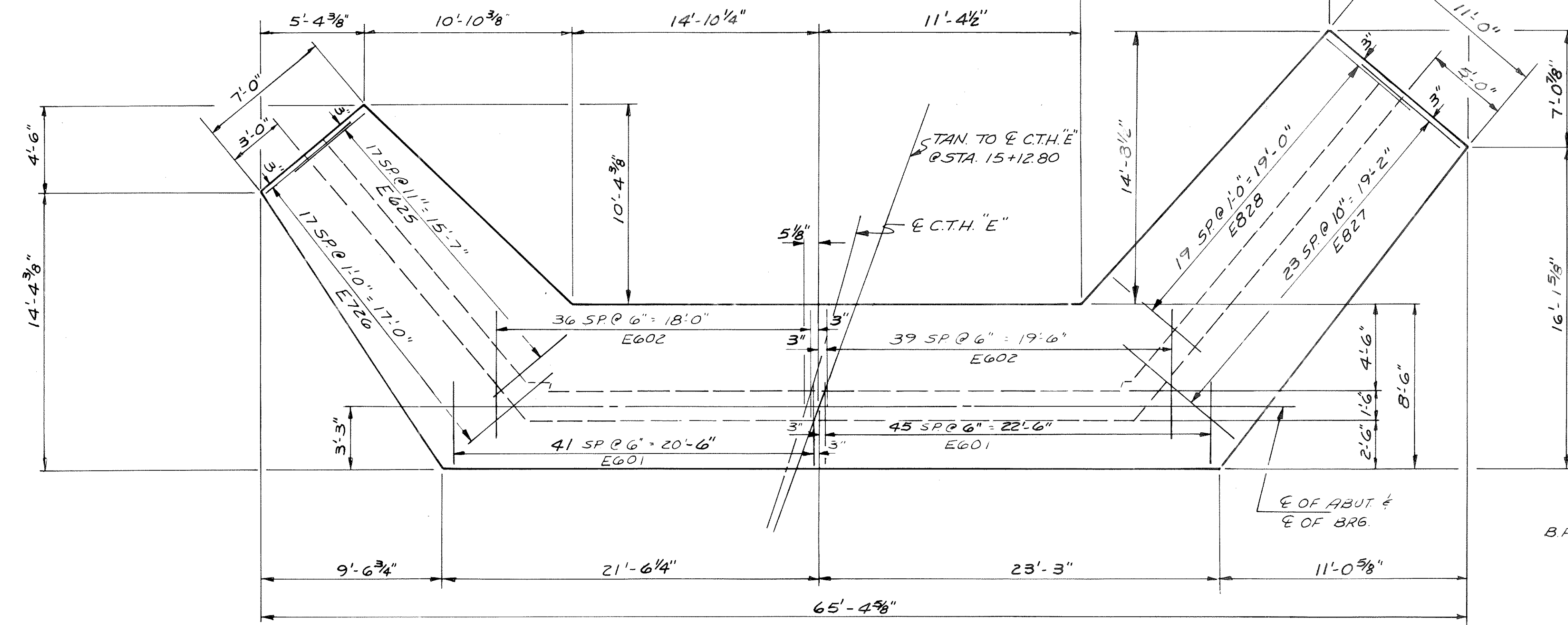

FOOTING PLAN

- 3/4" FILLER - SEAL ALL EXPOSED HORIZ & VERT SURFACES OF 3/4" FILLER WITH NON-STAINING GRAY, NON-BITUMINOUS JOINT SEALER (1" DEEP & HOLD 1/8" BELOW SURFACE OF CONC.) EXTEND FROM TOP OF FOOTING TO TOP OF WING.
- 1/2" FILLER & SEALER SEAL ALL EXPOSED HORIZ & VERT SURFACES OF 1/2" FILLER WITH NON-STAINING GRAY NON-BITUMINOUS JOINT SEALER. (1" DEEP & HOLD 1/8" BELOW SURFACE OF CONC.) EXTEND FROM TOP OF BODY TO TOP OF WING.
- POLYVINYL CHLORIDE WATERSTOP - TO EXTEND BETWEEN FACES OF WINGS, FROM TOP OF FOOTING TO TOP OF WING AND FROM TOP OF BODY TO TOP OF SLAB. (SEE DETAIL SHT. 8)
- ▲ CONST. JOINT - FORMED BY SURFACED, BEVELED 2"x6" KEYWAY, BETW. BEAM SEATS.
- CONST. JOINT - FORMED BY SURFACED, BEVELED 2"x6" KEYWAY.
- 4"x3/4" FILLER - BETW. WINGS EXCEPT UNDER GIRTS

NOTE E517 BARS MAY BE PLACED AFTER CONC IS POURED, BUT BEFORE INITIAL SET HAS TAKEN PLACE.

NOTE ABUTMENT SUPPORTED ON SPREAD FOOTINGS WITH A MIN. ALLOWABLE SOIL BEARING PRESSURE OF 3 TONS PER SQUARE FOOT.

** SEE FOUNDATION DATA SHT. 1

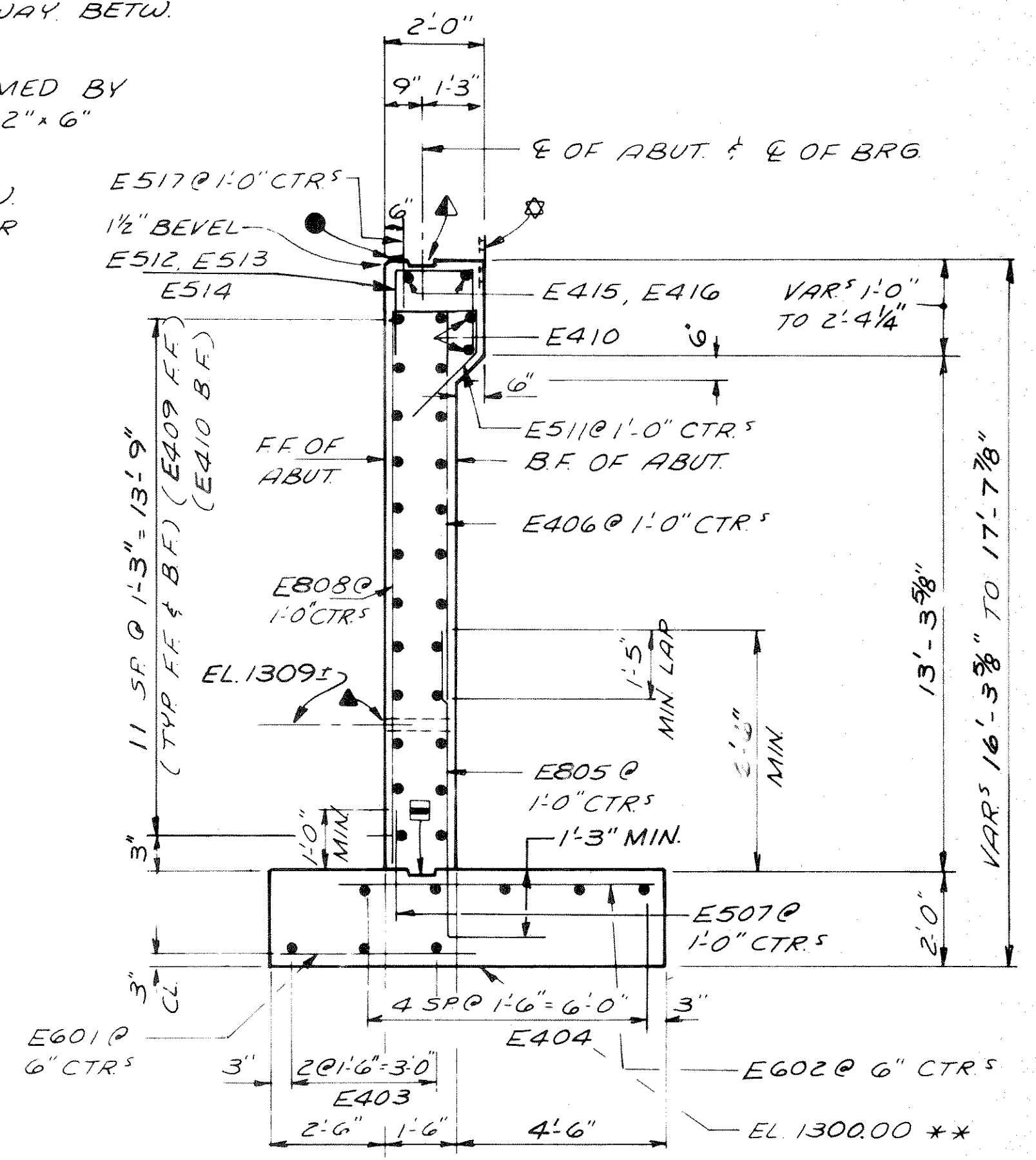

SECTION THRU BODY

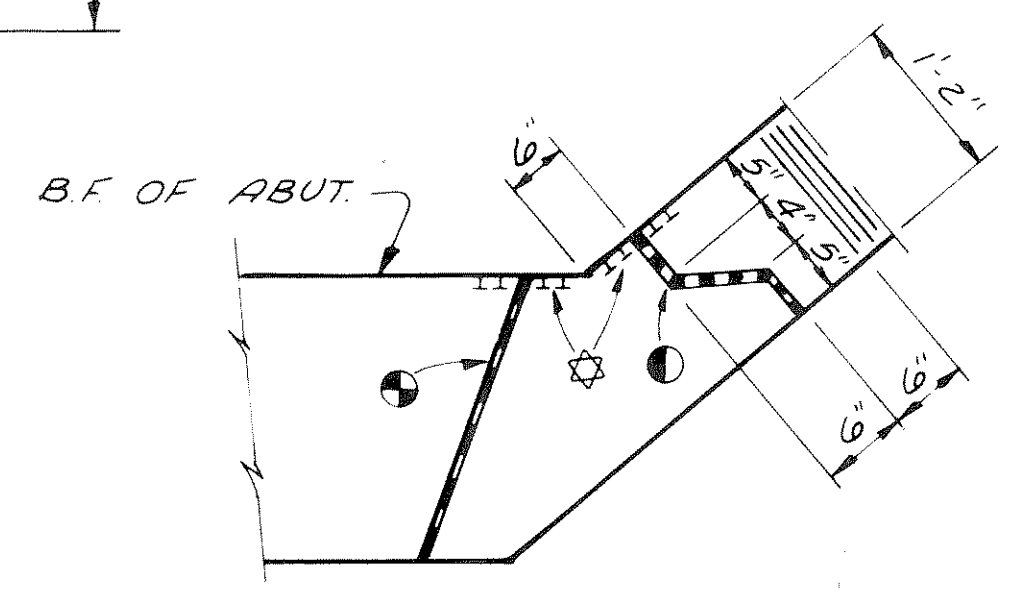

JOINT IN WINGS (TYP.)

No.	Date	Revision	By
STATE OF WISCONSIN DEPARTMENT OF TRANSPORTATION			
STRUCTURE B-35-84			
Const. Spec.	1981	Drawn By	NJA
		Plans Checked	RIS
NORTH ABUTMENT			SHEET 6 OF 11
X67857			