

**GENERAL NOTES**  
 DRAWINGS SHALL NOT BE SCALED.  
 BAR STEEL REINF. SHALL BE EMBEDDED 2" CLEAR UNLESS OTHERWISE SHOWN OR NOTED.  
 ELASTOMERIC BEARING PADS NEED NOT BE INDIVIDUALLY MOLDED PROVIDED THE CUT EDGES ARE SMOOTH AND TRUE.

**DESIGN DATA**  
 LIVELOAD  
 DESIGN RATING: HS20  
 INVENTORY RATING: HS22  
 OPERATIONAL RATING: HS40  
 STRUCTURE IS DESIGNED FOR A FUTURE WEARING SURFACE OF 20 POUNDS PER SQUARE FOOT.  
 ALLOWABLE DESIGN STRESSES  
 CONCRETE MASONRY SLAB \$c 4000 P.S.I. ALL OTHER \$c 3500 P.S.I.  
 BAR STEEL REINFORCEMENT, GRADE 60 \$y 60,000 P.S.I.  
 36" PRESTRESSED GIRDERS, CONCRETE MASONRY \$c 6000 P.S.I.  
 STRANDS - 1/2" \$phi WITH ULTIMATE TENSILE STRENGTH OF 270,000 P.S.I.

**CURVE DATA**  
 P.I. = STA. 14+79.70  
 $\Delta = 39^{\circ}18'00''$   
 $D = 6^{\circ}$   
 $T = 340.974$   
 $L = 655.000$   
 $R = 954.930$   
 $P.C. = 11+38.73$   
 $P.T. = 17+93.73$  BK

NOTE: EXIST. STRUCTURE P-29 TO BE REMOVED.  
 NOTE: FOR EXIST. STRUCTURE LOCATION SEE SHT. 3.

**TRAFFIC VOLUME**  
 ADT (1982) = 480  
 ADT (2002) = 880  
 RDS = 50 MPH

**HYDRAULIC DATA**  
 $Q_{100} = 2800$  c.f.s.  
 $VEL = 6.9$  f.p.s.  
 $HW = 1314.2$   
 WATERWAY AREA = 408 s.f.  
 DRAINAGE AREA = 94.4 SQ. MI.  
 OVERTOPPING ROAD = N/A

- LIST OF DRAWINGS**
- |                                   |        |
|-----------------------------------|--------|
| 1. GENERAL PLAN                   | X67852 |
| 2. GENERAL PLAN                   | X67853 |
| 3. SUBSURFACE EXPLORATION         | X67854 |
| 4. SOUTH ABUTMENT                 | X67855 |
| 5. SOUTH ABUTMENT                 | X67856 |
| 6. NORTH ABUTMENT                 | X67857 |
| 7. NORTH ABUTMENT                 | X67858 |
| 8. ABUTMENT BILL OF BARS          | X67859 |
| 9. 36" PRESTRESSED GIRDER DETAILS | X67860 |
| 10. SUPERSTRUCTURE                | X67861 |
| 11. TUBULAR RAILING TYPE "F"      | X67862 |

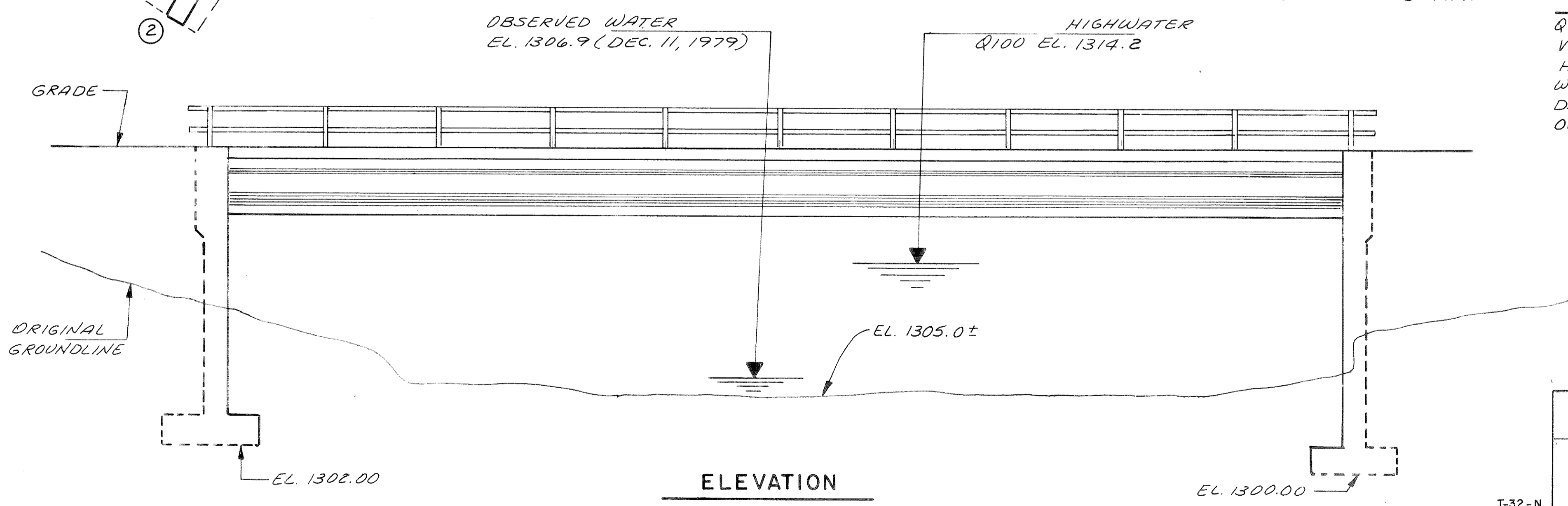
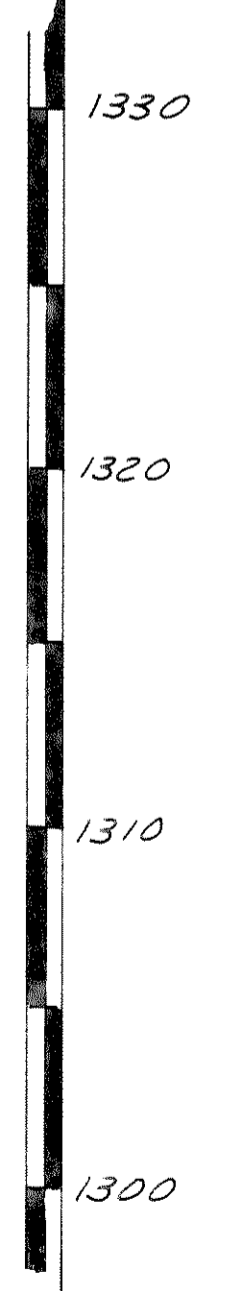

**FOUNDATION DATA**  
 ABUTMENTS SUPPORTED ON SPREAD FOOTINGS WITH A MIN. ALLOWABLE SOIL BEARING PRESSURE OF 3 TONS PER SQUARE FOOT.  
 ALL FOOTINGS SHALL BE FOUNDED ON SOUND ROCK. EXTRA TWO FOOT LENGTH IS PROVIDED IN THE FOOTING DOWELS TO ACCOMMODATE MINOR VARIATIONS FROM THE FOOTING ELEVATIONS SHOWN ON THE PLANS.

**BENCH MARK**

NO.	STA.	DESCRIPTION	ELEV.
4	16+12	R.R. SPIKE IN TELEPHONE POLE 50' RT.	1315.77

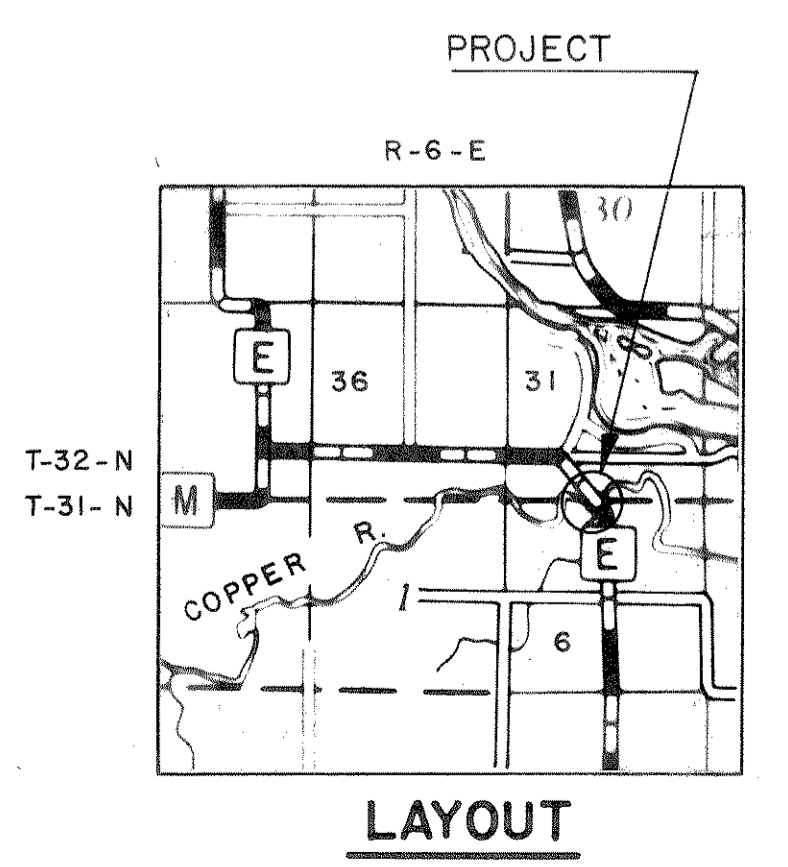

PLANS PREPARED BY:  
**MEAD & HUNT, INC.**  
 MADISON, WISCONSIN

No.	Date	Revision	By

STATE OF WISCONSIN  
 DEPARTMENT OF TRANSPORTATION  
**STRUCTURE B-35-84**  
 C.T.H. "E" OVER COPPER RIVER

County	LINCOLN	Town/Village	SCOTT
Design Spec.	AASHTO 77 & INTERIMS	Load	HS20
Design By	GAG	Const. Spec.	1981
Checked	RIS	Drawn	NJA
By		Plans	RIS
Checked		By	

Approved: \_\_\_\_\_ Chief Bridge Engineer Date: \_\_\_\_\_

GENERAL PLAN	SHEET 1 OF 11
X67852	