

INDEX OF SHEETS

SHEET NO. 1	TITLE
SHEET NO.	TYPICAL CROSS SECTIONS
SHEET NO.	ESTIMATE OF QUANTITIES
SHEET NO.	MISCELLANEOUS QUANTITIES
SHEET NO.	RIGHT OF WAY PLAT
SHEET NO.	PLAN AND PROFILE STA. 7+00 TO STA. 16+00
SHEET NO.	STANDARD DETAILS
SHEET NO.	DRAINAGE STRUCTURES
SHEET NO.	CROSS SECTIONS

COUNTY AND HIGHWAY	ROUTE AND SECTION	CLASS AND AGREEMENT		B.P.A. REGION DIVISION	SHEET NUMBER	TOTAL SHEETS
		STATE	FEDERAL			
35.6	0.0		3.13	4 WIS.	/	//

STATE OF WISCONSIN
STATE HIGHWAY COMMISSION OF WISCONSIN

PLAN AND PROFILE OF PROPOSED

COPPER RIVER BRIDGE

C. T. H. "M"
LINCOLN COUNTY
PROJECT E 0-0(13)

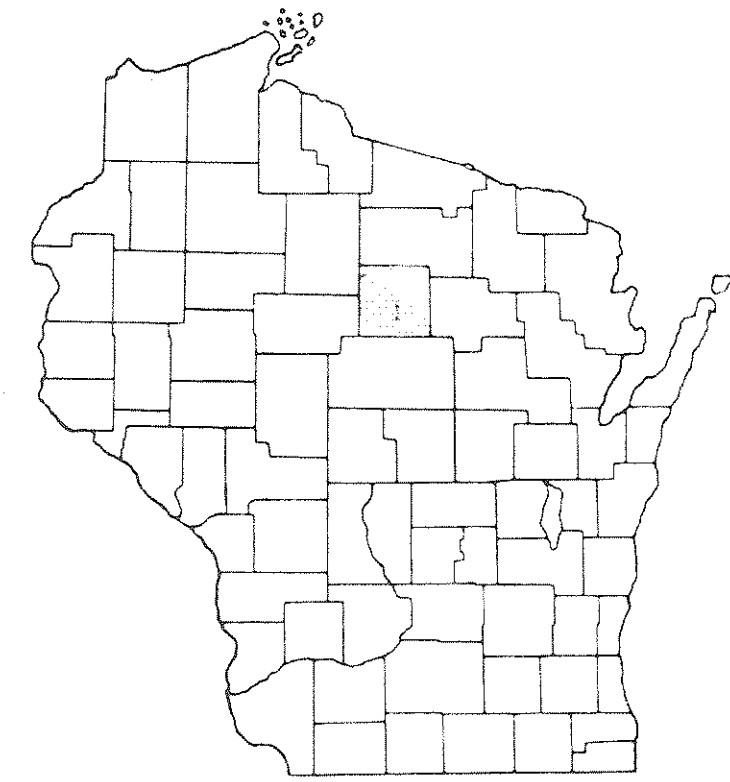

PLAN 1 IN. = 100 FT.
PROFILE HOR. 1 IN. = 100 FT. VERT. 1 IN. = 10 FT.
CROSS SECTIONS HOR. 1 IN. = 5 FT. VERT. 1 IN. = 5 FT.

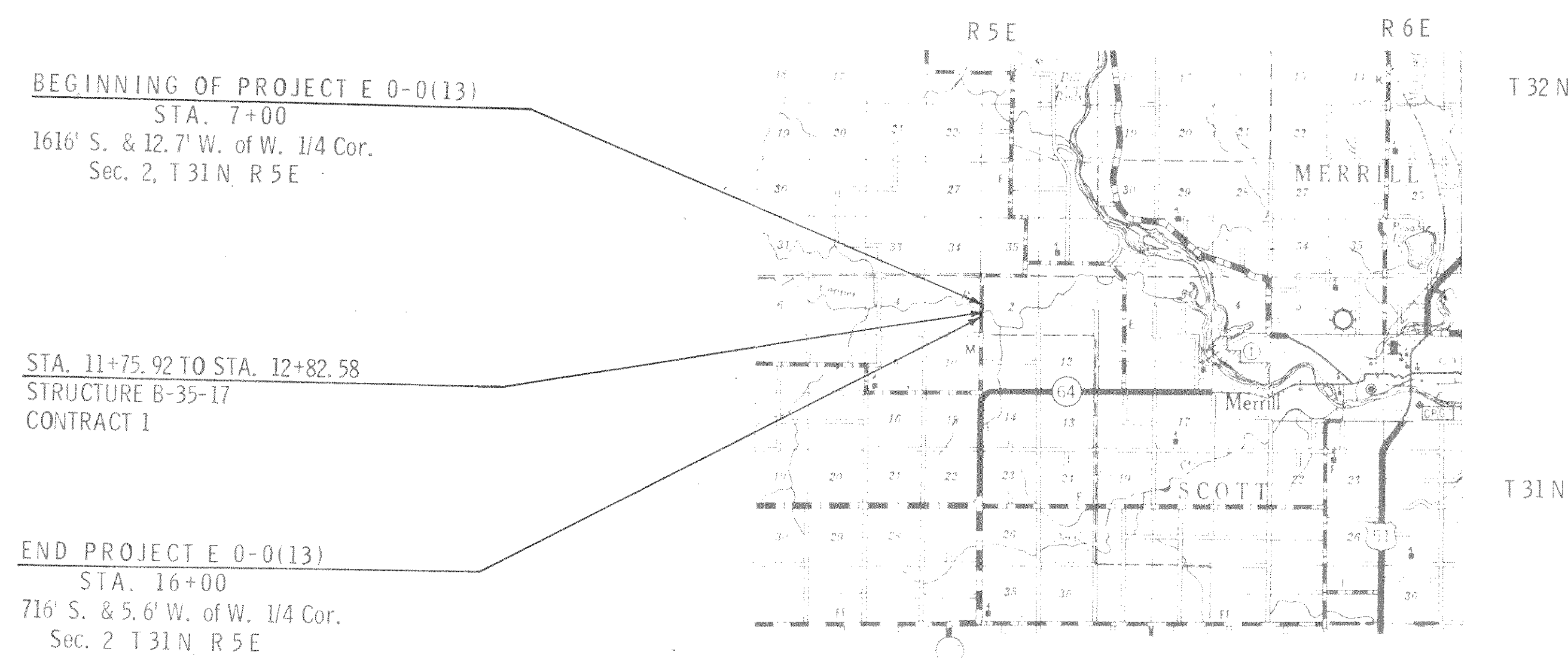

CONVENTIONAL SIGNS

STATE LINE	CULVERTS IN PLACE
COUNTY LINE	CULVERTS REQUIRED
TOWNSHIP OR RANGE LINE	DROP INLET
SECTION LINE	POWER POLE
NEW RIGHT OF WAY LINE	TELEPHONE OR TELEGRAPH POLE
PRESENT RIGHT OF WAY LINE	RIGHT OF WAY MARKERS
WIRE FENCE { WOVEN	REFERENCE STAKE FOR HUBS ONLY
{ BARBED	MARSH
LOT LINE	HEDGE
CORPORATE OR CITY LIMITS	TREES
PROPERTY LINE P.L. + 32.6		
TRAVELED WAY OR P.E.	GROUND ELEVATION DATUM LINE 73.9
RAILROADS	GRADE ELEVATION DATUM LINE 75.16
BASE OR SURVEY LINE 30		

LAYOUT
SCALE 2 MILES

TOTAL NET LENGTH OF CENTERLINE = 0.170 MI.

STATE HIGHWAY COMMISSION OF WISCONSIN MADISON, WIS.	
SURVEYOR SONNENBERG	NOTE BOOK 272
DIVISION COMPUTER MCOWN	M. D. CHECKER
DISTRICT CHECKER	CORRECT
CORRECT:	
DATE 8/15/66	<i>M. D. Tuttle</i> DISTRICT ENGINEER
RECOMMENDED FOR APPROVAL:	
DATE	
APPROVED:	
DATE	STATE HIGHWAY ENGINEER
DEPARTMENT OF COMMERCE BUREAU OF PUBLIC ROADS	
APPROVED:	
DATE	
DIVISION ENGINEER	