

STATE PROJECT NUMBER	9427-01-70	SHEET NO.	5
PLAN & PROFILE CTH 'H' BRIDGE & APPROACHES			
TOWN OF KING, LINCOLN COUNTY			

BENCHMARKS			
NO.	STATION	DESCRIPTION	ELEV.
1	10+11	CHISELED SQUARE ON N.E. WINGWALL 13' RT.	1462.23
2	12+43	RR SPIKE IN S.E. FACE DOUBLE 20' RED PINE 33' LT.	1464.80
3	11+05	RR SPIKE IN W. FACE 30' WHITE PINE 38' RT.	1463.19

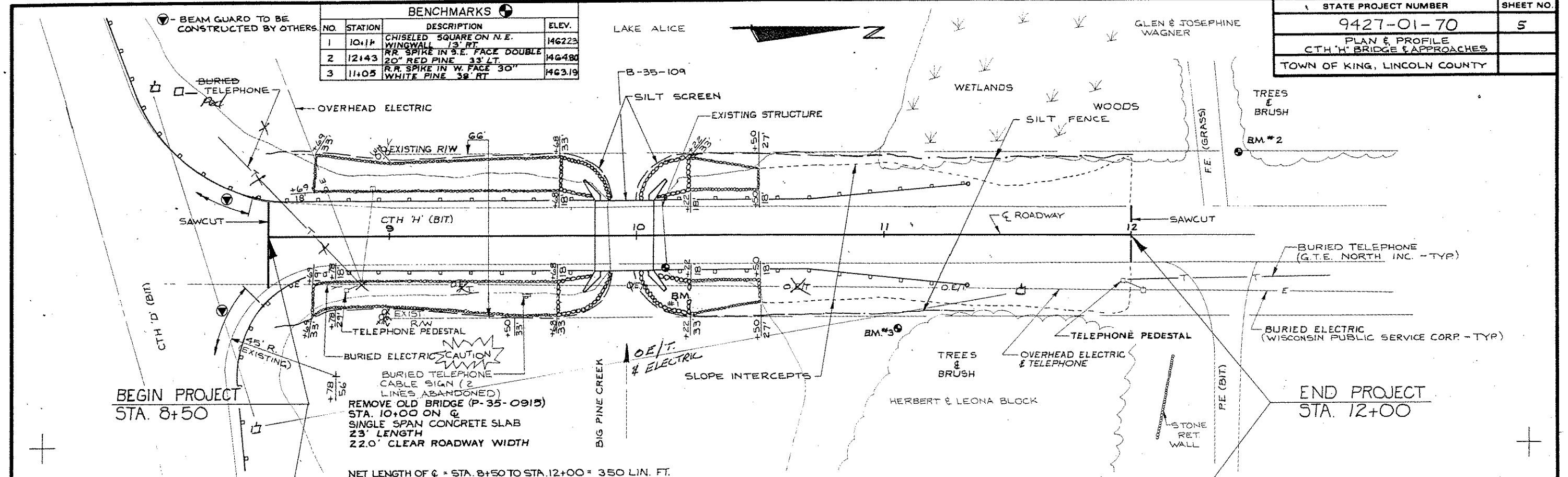

BEGIN PROJECT  
STA. 8+50

END PROJECT  
STA. 12+00

NET LENGTH OF G = STA. 8+50 TO STA. 12+00 = 350 LIN. FT.

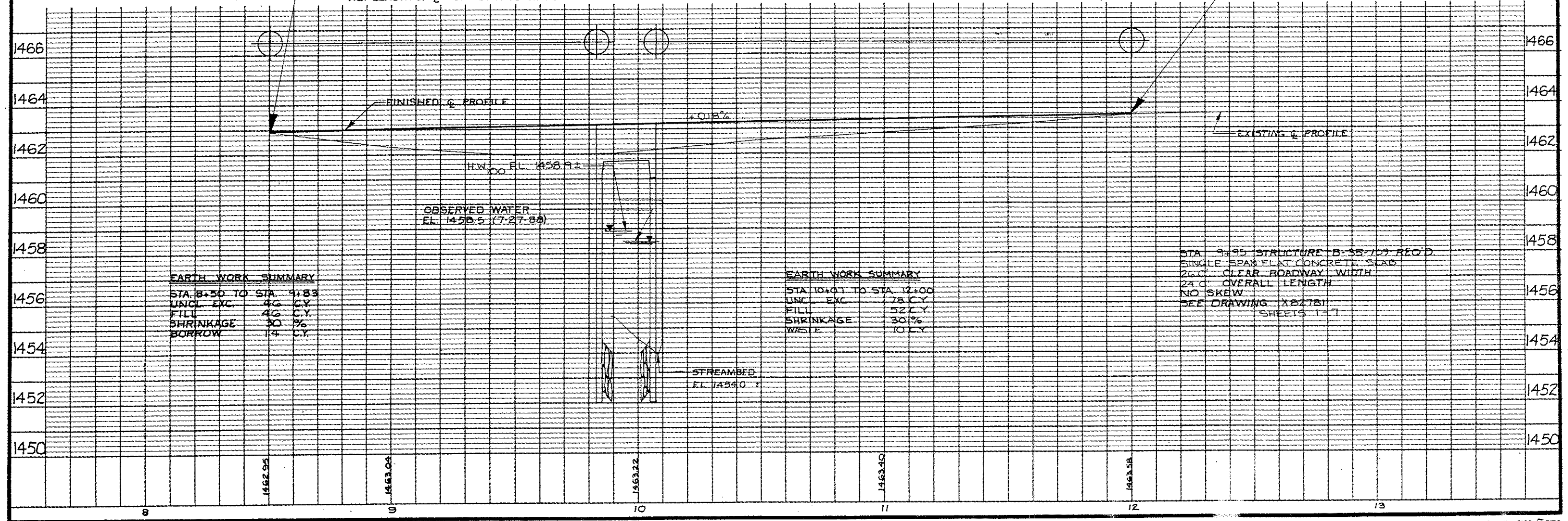

STA. 9+95 STRUCTURE B-35-109 RECD.  
SINGLE SPAN FLAT CONCRETE SLAB  
22.0' CLEAR ROADWAY WIDTH  
24.0' OVERALL LENGTH  
NO SKEW  
SEE DRAWING 122781  
SHEETS 1-7