

AS BUILT PLAN

STATE OF WISCONSIN
DEPARTMENT OF TRANSPORTATION

PLAN OF PROPOSED IMPROVEMENT

BIG PINE CREEK BRIDGE AND APPROACHES

C.T.H. "H"
LINCOLN COUNTY

STATE PROJECT NUMBER
9427-01-70

STATE PROJECT	FEDERAL PROJECT	
	PROJECT	CONTRACT
9427-01-70	—	—

Index of Sheets

Sheet No.	1	Title
Sheet No.	2	Typical Sections and Details
Sheet No.	3-3.1	Estimate of Quantities
Sheet No.	2	Miscellaneous Quantities
Sheet No.	—	Right of Way Plat
Sheet No.	5	Plan and Profile
Sheet No.	6-6.6	Standard Detail Drawings
Sheet No.	—	Standard Sign Plates
Sheet No.	8.6	Structure Plans
Sheet No.	—	Computer Earthwork Data
Sheet No.	9-9.1	Cross Sections

TOTAL SHEETS = 21

Project Engineer: Donohue & Associates
 Eugene Seidler, PR
 Project Personnel: Indexed in Diary #

Contractor: Ruzic Construction Co.
 Subs: American Asphalt of Wis.
 Barricade Flasher Service
 Central Sand & Gravel, Inc.
 Red Cedar Steel Erectors, Inc.
 Timme, Inc.
 Traffic Signing & Marking, Inc.

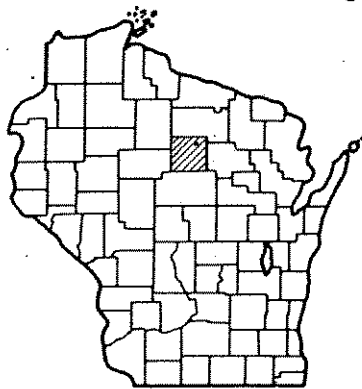

Design Designation

A.D.T.	1989	=	190
A.D.T.	2009	=	230
D.H.V.	2009	=	40
D.		=	60/40
T.		=	6 %

Conventional Signs

County Line	-----
Township or Range Line	-----
Section Line	-----
Corporate or City Limits	-----
Property line	-----
Lot Line	-----
Existing Right of Way Line	-----
New Right of Way Line	-----
Base or Survey Line	-----
Slope Intercept	-----
Existing Roadway or Private Entrance	-----

Caution Symbol (Combustible fluids under pressure)	
Railroads	-----
Fence	-----
Culverts in Place	-----
Culverts Required	-----
Power Pole	-----
Telephone or Telegraph Pole	-----
Right of Way Markers	-----
Marsh	-----
Wooded Area	-----
Grade Elevation	-----

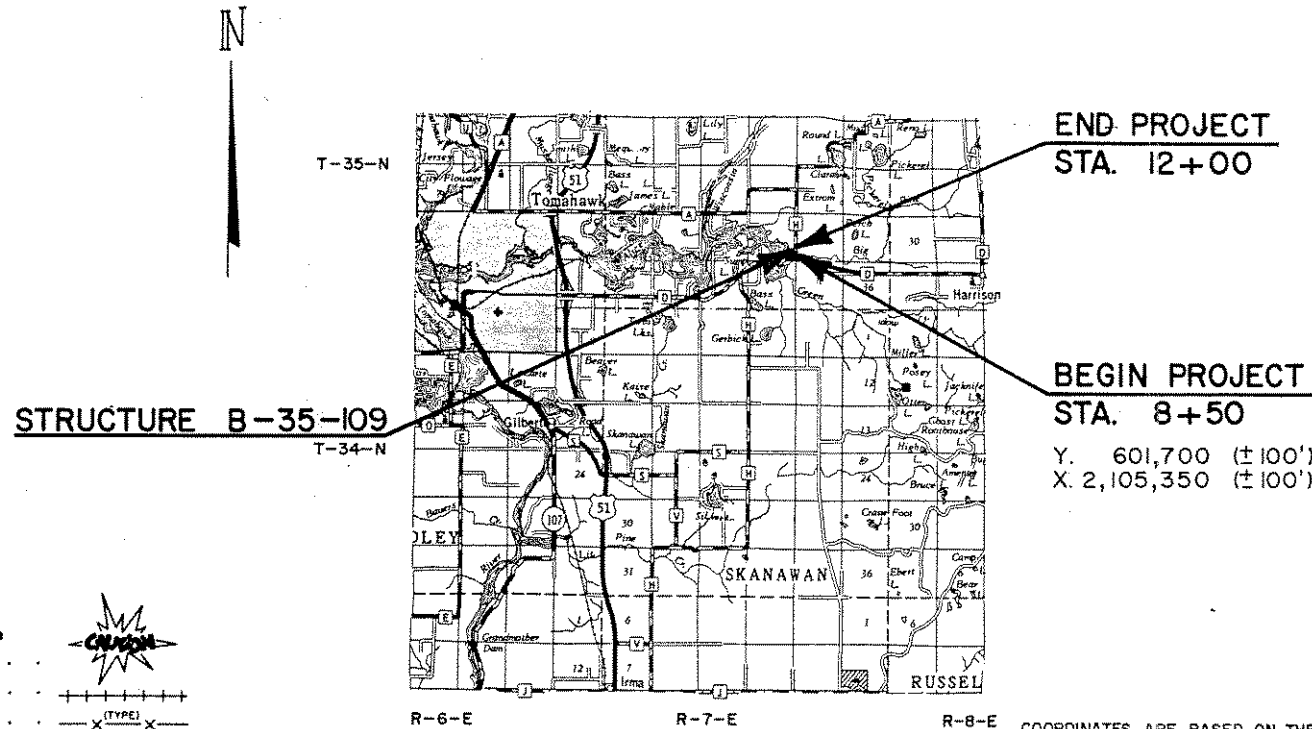

STRUCTURE B-35-109

END PROJECT
 STA. 12+00

BEGIN PROJECT
 STA. 8+50

Y. 601,700 (±100')
 X. 2,105,350 (±100')



Total Net Length of Centerline = 0.066 Mi. (Rural)

COORDINATES ARE BASED ON THE WISCONSIN COORDINATE SYSTEM, CENTRAL ZONE, AND ARE SCALED FROM THE U.S.G.S. TOPOGRAPHIC MAP, HARRISON, WISCONSIN QUADRANGLE FOR IDENTIFICATION ONLY.

ELEVATIONS SHOWN ON THIS PLAN ARE REFERENCED TO U.S.G.S. DATUM, A CHISELED SQUARE ON THE N.E. WINGWALL OF THE EXISTING BRIDGE, ELEVATION 1462.23.

APPROVED FOR
 LINCOLN COUNTY

10/02/89 DATE Michael L. Heup COMMISSIONER

ORIGINAL PLANS
 PREPARED BY

NSA MID-STATE ASSOCIATES, INC.
 1230 S. Blvd., Baraboo, WI 53913

Marvin S. Ruhland
 ENGINEER
 9-26-89 DATE

STATE OF WISCONSIN
 DEPARTMENT OF TRANSPORTATION

Surveyor MID-STATE ASSOC. District Checker F.W.B.
 Designer MID-STATE ASSOC. C.O. Checker DL
 District Supervisor R.S. C.O. Coordinator L.A.S.

Approved:
 Date 12-8-89 James D. Heurdelier District Director

Approved:
 Date 12/28/89 Robert W. Berg Regional Chief Road Design Engineer

U.S. DEPARTMENT OF TRANSPORTATION
 FEDERAL HIGHWAY ADMINISTRATION
 REGION 5 WISCONSIN DIVISION

Approved:
 Date _____ Division Administrator