

COUNTY AND HIGHWAY	ROUTE AND SECTION	CLASS AND AGREEMENT		S.P.R. REGION DIVISION	SHEET NUMBER	TOTAL SHEETS
		STATE	FEDERAL			
35.6	570.0		11.10	4 WIS.	1	13

INDEX OF SHEETS

SHEET NO. 1 TITLE
SHEET NO. 2 TYPICAL CROSS SECTIONS
SHEET NO. 2 ESTIMATE OF QUANTITIES
SHEET NO. 2A MISCELLANEOUS QUANTITIES
SHEET NO. — RIGHT OF WAY PLAT
SHEET NO. 3 PLAN AND PROFILE STA. 53+00 TO STA. 62+00
SHEET NO. 4-4.1 STANDARD DETAILS
SHEET NO. 5-11 DRAINAGE STRUCTURES
SHEET NO. 12-13 CROSS SECTIONS

STATE OF WISCONSIN
STATE HIGHWAY COMMISSION OF WISCONSIN

PLAN AND PROFILE OF PROPOSED
BIG HAYMEADOW CREEK BRIDGE AND APPROACHES
C.T.H "X"
LINCOLN COUNTY
PROJECT S 0570(10)

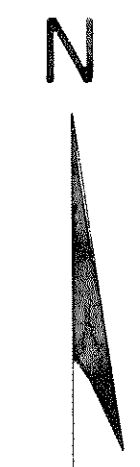
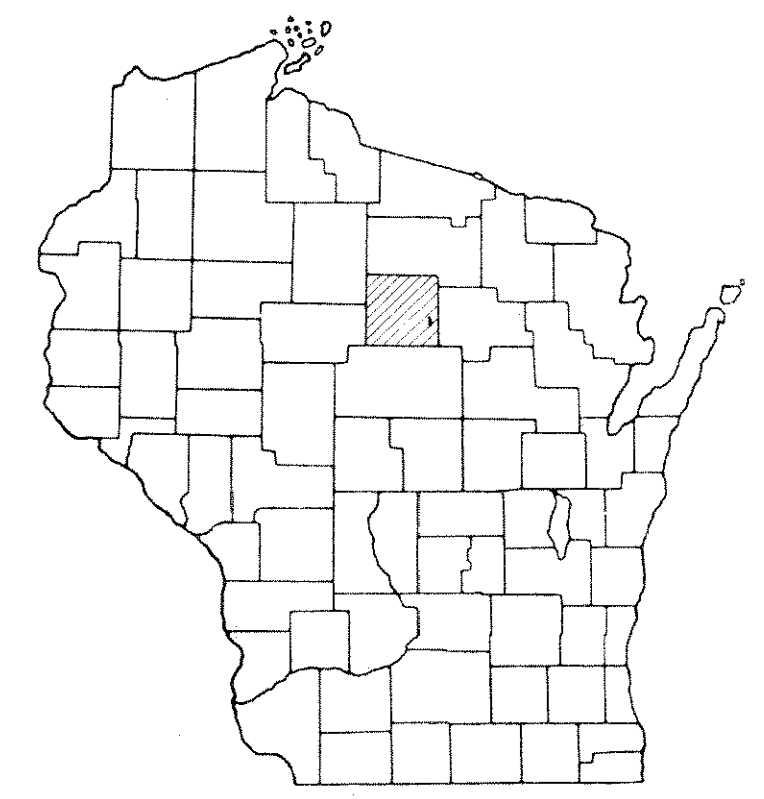

PLAN 1 IN. = 100 FT.
PROFILE HOR. 1 IN. = 100 FT. VERT. 1 IN. = 10 FT.
CROSS SECTIONS HOR. 1 IN. = 5 FT. VERT. 1 IN. = 5 FT.

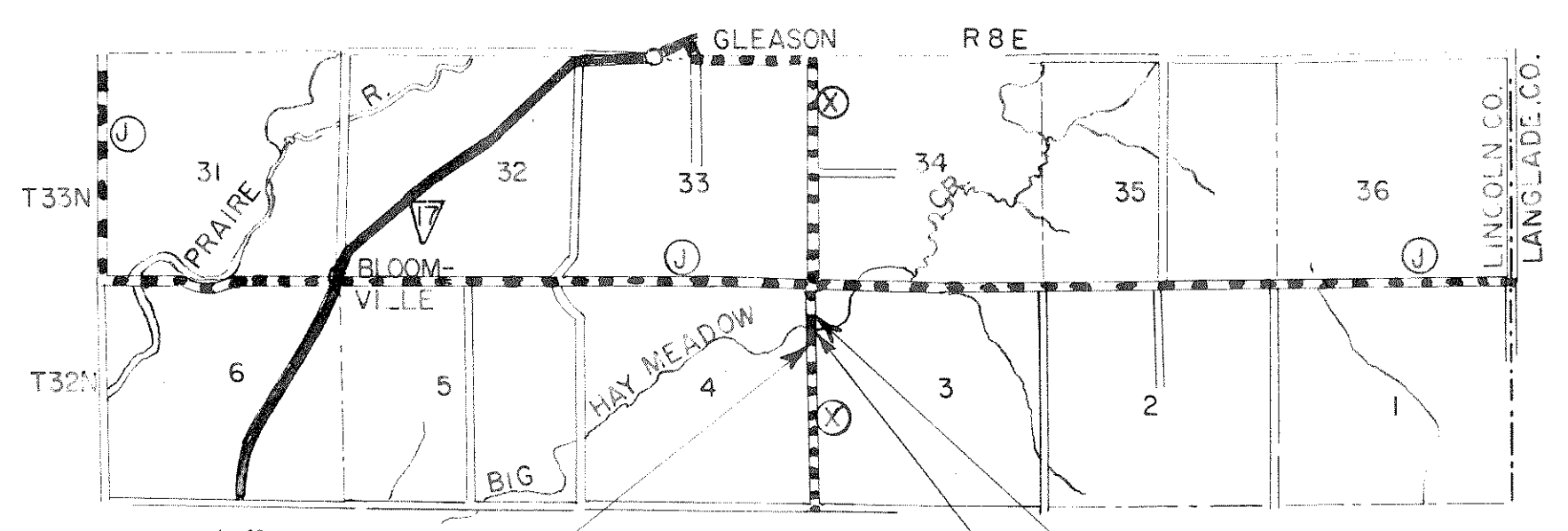

BEGINNING OF PROJECT S 0570(10)
STA. 53+00
1629.2 FT. S. OF N.W. COR.
SEC. 3, T32N, R9E

END OF PROJECT S 0570(10)
STA. 62+00
726.2 FT. S. OF N.W. COR.
SEC. 3, T32N, R9E

STA. 57+15.08 - STA. 57+86.92
BRIDGE B - 35-4
CONTRACT NO. 1

LAYOUT
SCALE 1 MILE

TOTAL NET LENGTH OF CENTERLINE = 0.170 MI.

CONVENTIONAL SIGNS

STATE LINE	-----	CULVERTS IN PLACE	-----
COUNTY LINE	-----	CULVERTS REQUIRED	-----
TOWNSHIP OR RANGE LINE	-----	DROP INLET	-----
SECTION LINE	-----	POWER POLE	-----
NEW RIGHT OF WAY LINE	-----	TELEPHONE OR TELEGRAPH POLE	-----
PRESENT RIGHT OF WAY LINE	-----	RIGHT OF WAY MARKERS	-----
WIRE FENCE { WOVEN	-----	REFERENCE STAKE FOR HUBS ONLY	-----
{ BARBED	-----	MARSH	-----
LOT LINE	-----	HEDGE	-----
CORPORATE OR CITY LIMITS	-----	TREES	-----
PROPERTY LINE	-----		
TRAVELED WAY OR P.E.	-----	GROUND ELEVATION	DATUM LINE 73.9
RAILROADS	-----	GRADE ELEVATION	DATUM LINE 75.16
BASE OR SURVEY LINE	-----		

STATE HIGHWAY COMMISSION OF WISCONSIN
MADISON, WIS.

SURVEYOR P. JOHNSON NOTE BOOK 8193
DIVISION COMPUTER E.H.M. M.O. CHECKER W.H.B.
DISTRICT CHECKER CORRECT

CORRECT:
DATE 4/1/64 Max J. Jetté DISTRICT ENGINEER

RECOMMENDED FOR APPROVAL:
DATE 6/2/64 Chief Design Engineer

APPROVED:
DATE 6/2/64 State Highway Engineer

DEPARTMENT OF COMMERCE
BUREAU OF PUBLIC ROADS

APPROVED: [Redacted] DATE [Redacted]
[Redacted] DIVISION ENGINEER

S 0570(10)