

BORINGS PERFORMED BY:
 SOILS & ENGINEERING SERVICES, INC.
 1120 STEWART STREET
 MADISON, WISCONSIN 53713
 BORINGS PERFORMED ON AUGUST 13, 1985

STATE PROJECT NUMBER SHEET NO.

9859-03-70

ABBREVIATIONS

F — Fine M — Medium C — Coarse
 Ws — Weathered So — Sound

MATERIAL SYMBOLS

LEGEND OF PROBING

95/6 = 95 Blows for 6" Penetration
 Probing taken with a 350# Wt. Falling 18" on a 2" O.D. Point

Probing No. Sta. Elevation
 7 Average Blows Per Foot
 Refusal 95/6

LEGEND OF BORING

Unconfined Strength → 7.7
 Blows Per Ft. Using 140# Wt. Falling 30"
 Wash Sample
 Shell by Tube — S.T.
 Ground Water Elevation
 No Ground Water Observed Above This Elevation

Sandy Gravel
 F.
 Boulders or Cobbles
 Sand
 Silty Clay
 So
 Limestone

Unless otherwise specified, the blows per foot at the locations indicated are based on driving a 2" O.D. x 1.4" I.D. split spoon sampler with a 140# hammer having a free fall of 30". The blow count is taken in undisturbed soil immediately below a cased or open hole eliminating side friction on the drive pipe.

SUBSURFACE EXPLORATION FOR FOUNDATION DESIGN AND BIDDERS INFORMATION

To obtain relative data concerning the character of material in and upon which the foundation might be built, borings and/or soundings were made at points approximately as indicated on this drawing. The data presented herein represents the findings of the subsurface explorations made. However, because the depths investigated are limited and the area of the borings and/or soundings is very small in relation to the entire area, the Division of Highways does not warrant conditions below the depths investigated or that the classification of material encountered in these investigations is necessarily typical of the entire site.

No.	Date	Revision	By
STATE OF WISCONSIN DEPARTMENT OF TRANSPORTATION			
STRUCTURE B-35-94			
Const. Spec.	WIS. 1981	Drawn By	D. J. A.
		Plans Checked	JRL
SUBSURFACE EXPLORATION			SHEET 3 OF 12 X78469

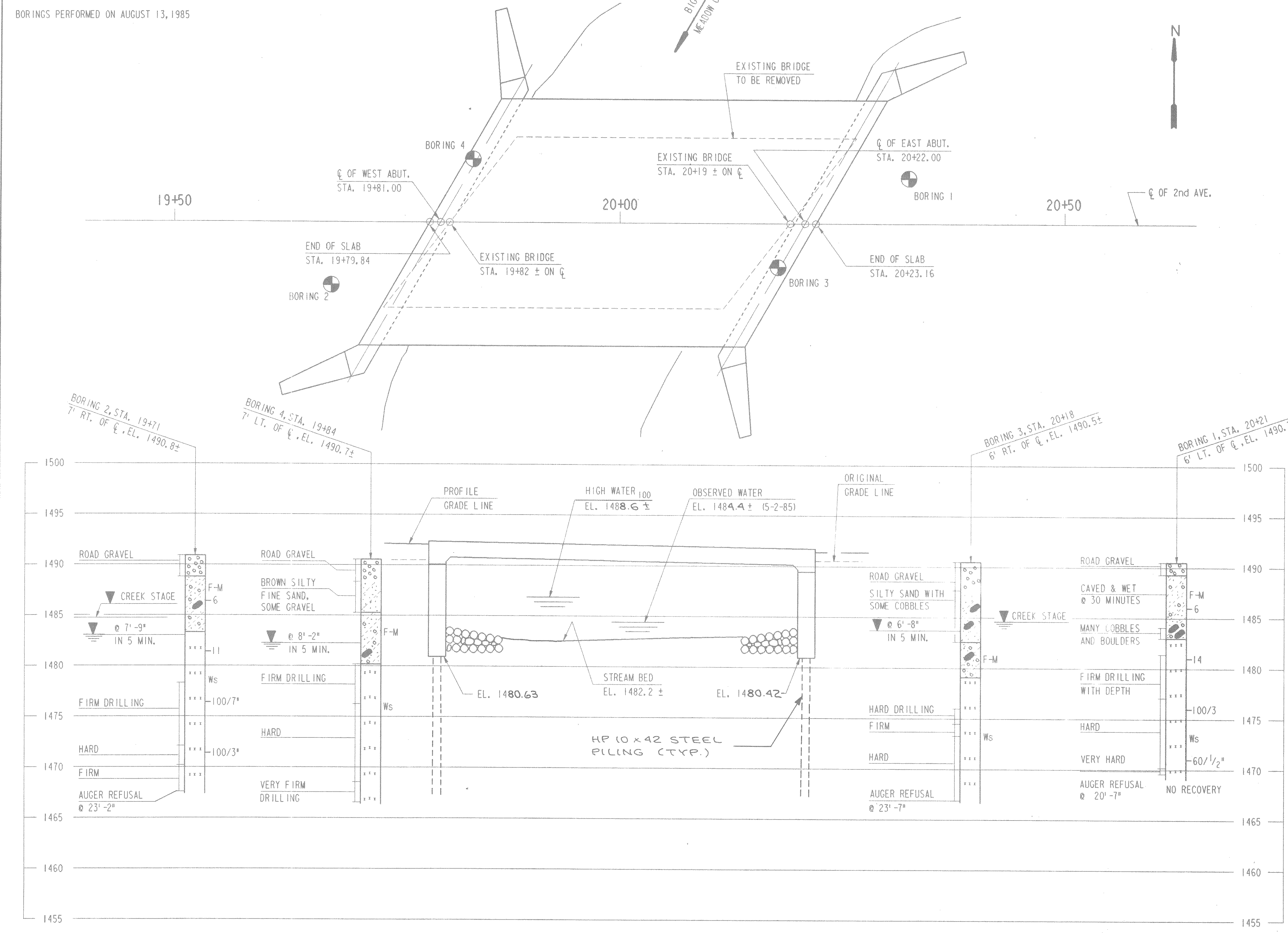

DATE= 08-28-85
 PRF= BORING
 FILE= BORING.SHT