

DESIGN DATA

LIVELOAD

DESIGN RATING: HS-20
 INVENTORY RATING: HS-23
 OPERATIONAL RATING: HS-38
 STRUCTURE IS DESIGNED FOR A FUTURE WEARING SURFACE OF 20 POUNDS PER SQUARE FOOT.

ALLOWABLE DESIGN STRESSES

CONCRETE MASONRY - SLAB $f'_c = 4,000$ p.s.i.
 - ALL OTHER $f'_c = 3,500$ p.s.i.
 HIGH - STRENGTH BAR STEEL REINFORCEMENT, GRADE 60 $f_y = 60,000$ p.s.i.

FOUNDATION DATA

ABUTMENTS TO BE SUPPORTED ON HP 10 x 42 STEEL PILES EST. 20'-0" LONG PREBORED TO EL. 1467±. DESIGN IS BASED ON A MINIMUM BEARING VALUE OF 55 TONS PER PILE.

HYDRAULIC DATA

100 YEAR FREQUENCY

DRAINAGE AREA 24.9 sq. mi.
 Q_{100} 1000 c.f.s.
 VELOCITY 8.8 f.p.s.
 WAERWAY AREA 113 sq. ft.
 HIGH WATER₁₀₀ ELEVATION 1488.6±

ROAD OVERTOPPING NOT APPLICABLE

TRAFFIC DATA

A. D. T. (1986) = 85
 A. D. T. (2006) = 135
 DESIGN SPEED = 40 M.P.H.

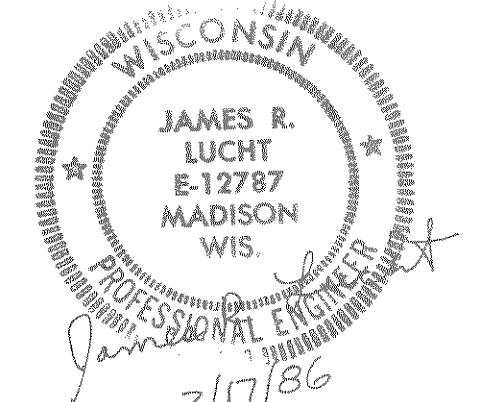

LIST OF DRAWINGS

1. GENERAL PLAN — X78467
2. GENERAL PLAN — X78468
3. SUBSURFACE EXPLORATION — X78469
4. WEST ABUTMENT — X78470
5. WINGS 1 & 2 — X78471
6. EAST ABUTMENT — X78472
7. WINGS 3 & 4 — X78473
8. ABUTMENT DETAILS — X78474
9. ABUTMENT DETAILS — X78475
10. SUPERSTRUCTURE — X78476
11. SUPERSTRUCTURE — X78477
12. TUBULAR RAILING, TYPE F-X78478

BENCH MARK

NO.	STATION	DESCRIPTION	ELEV.
1	19+89	CHISELED "□" ON N.W. WHEEL GUARD	1491.10

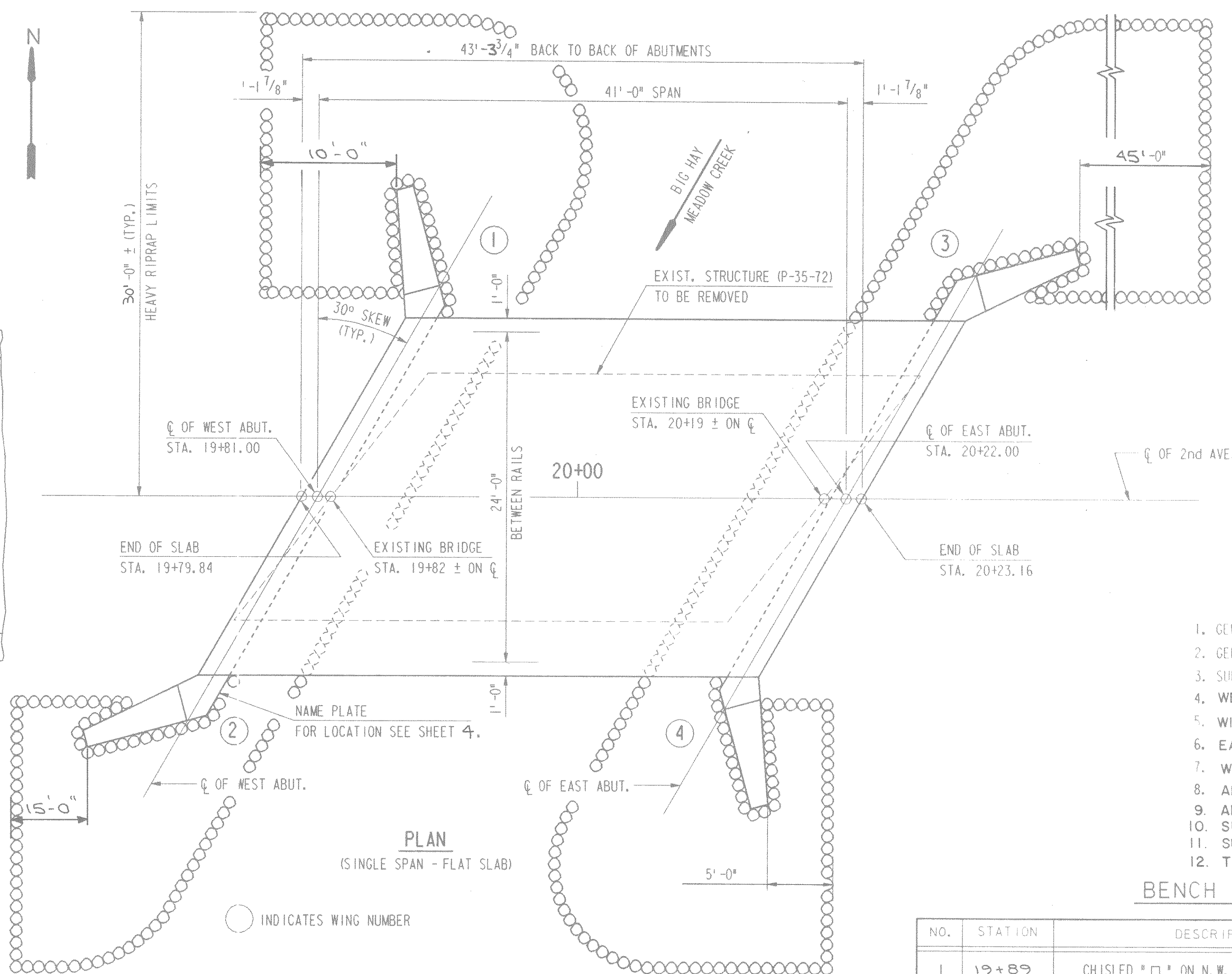

PLAN
(SINGLE SPAN - FLAT SLAB)

○ INDICATES WING NUMBER

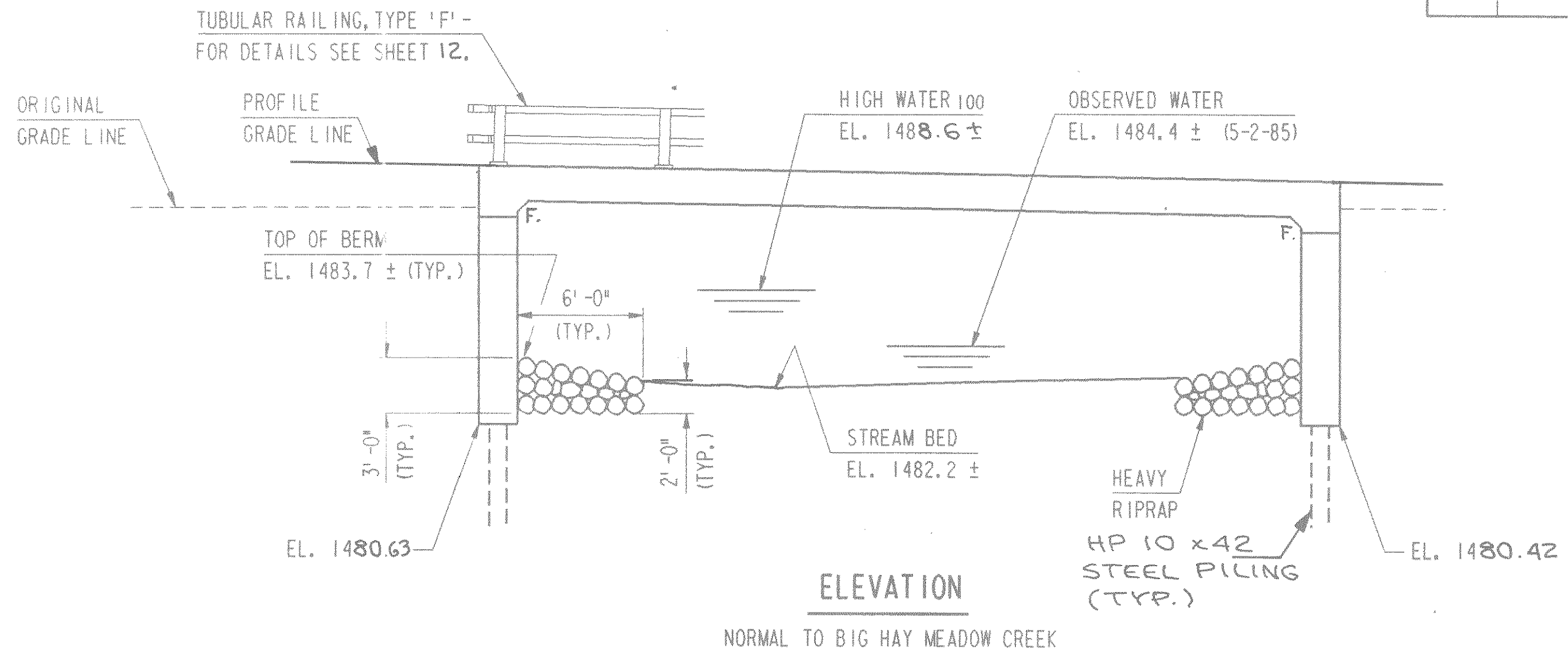
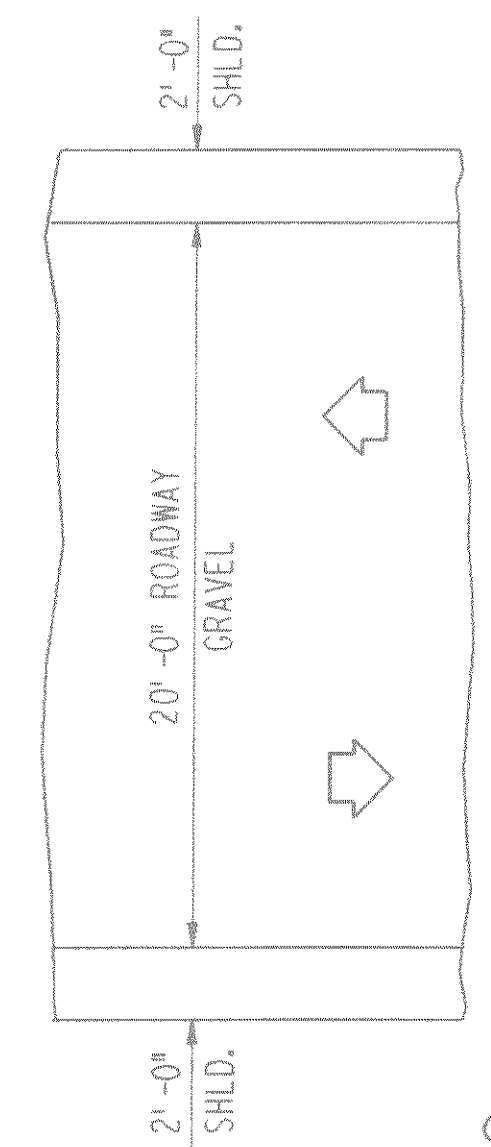

ELEVATION
NORMAL TO BIG HAY MEADOW CREEK

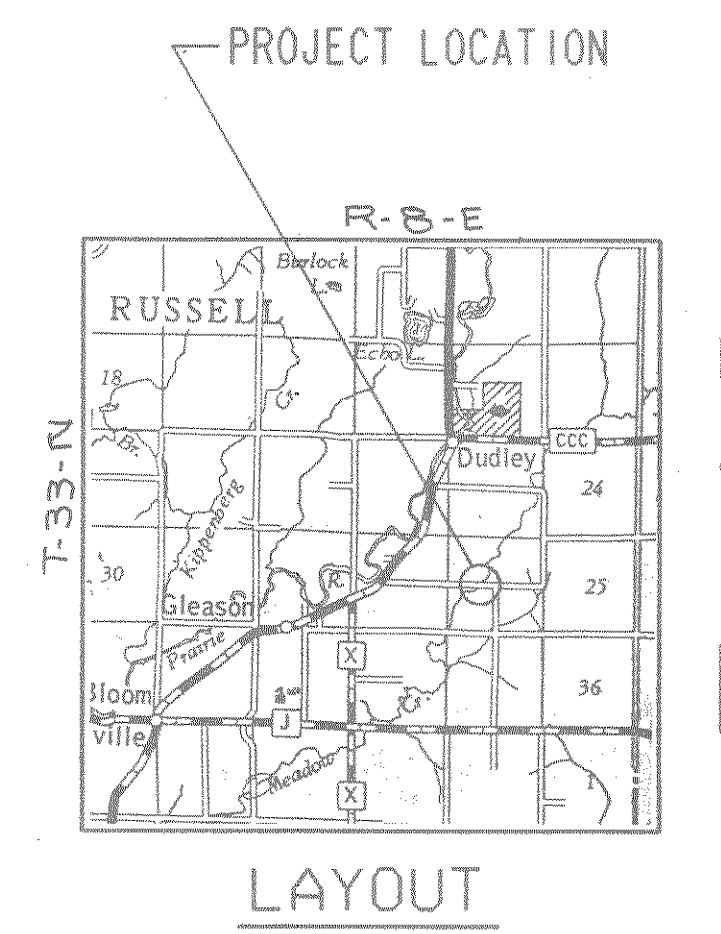

LAYOUT

No.	Date	Revision	By

Donohue
 Engineers & Architects
 COMPUTER AIDED DESIGN/DRAFTING

STATE OF WISCONSIN
 DEPARTMENT OF TRANSPORTATION

STRUCTURE B-35-94
 2nd AVENUE OVER BIG HAY MEADOW CREEK

County	LINCOLN	TOWN OF	RUSSELL
Design Spec.	AASHTO 1984	Load	HS20
Design By	B. D.	Checked	JRL
Drawn By	D. F. K.	Plans Checked	JRL

Approved _____ State Bridge Engineer _____ Date _____

GENERAL PLAN

SHEET 1 OF 12
 X78467

PREPARED BY: GENPLAN (1460001)
 FILE: GENPLAN - PRE
 W.U. = 11/2/6000
 DATE: 11/28/85