

Index of Sheets

| | |
|-------------|--|
| Sheet No. 1 | Title |
| Sheet No. | Typical Sections and Details |
| Sheet No. | Estimate of Quantities |
| Sheet No. | Miscellaneous Quantities |
| Sheet No. | Right of Way Plat |
| Sheet No. | Plan and Profile Sta. 18+00 - Sta. 24+00 |
| Sheet No. | Standard Detail Drawings |
| Sheet No. | Standard Sign Plates |
| Sheet No. | Structure Plans |
| Sheet No. | Computer Earthwork Data |
| Sheet No. | Cross Sections |

TOTAL SHEETS =



STATE OF WISCONSIN DEPARTMENT OF TRANSPORTATION

PLAN OF PROPOSED IMPROVEMENT BIG HAY MEADOW CREEK BRIDGE AND APPROACHES

2ND AVENUE
TOWN ROAD
LINCOLN COUNTY

STATE PROJECT NUMBER
9859-03-70

Scales

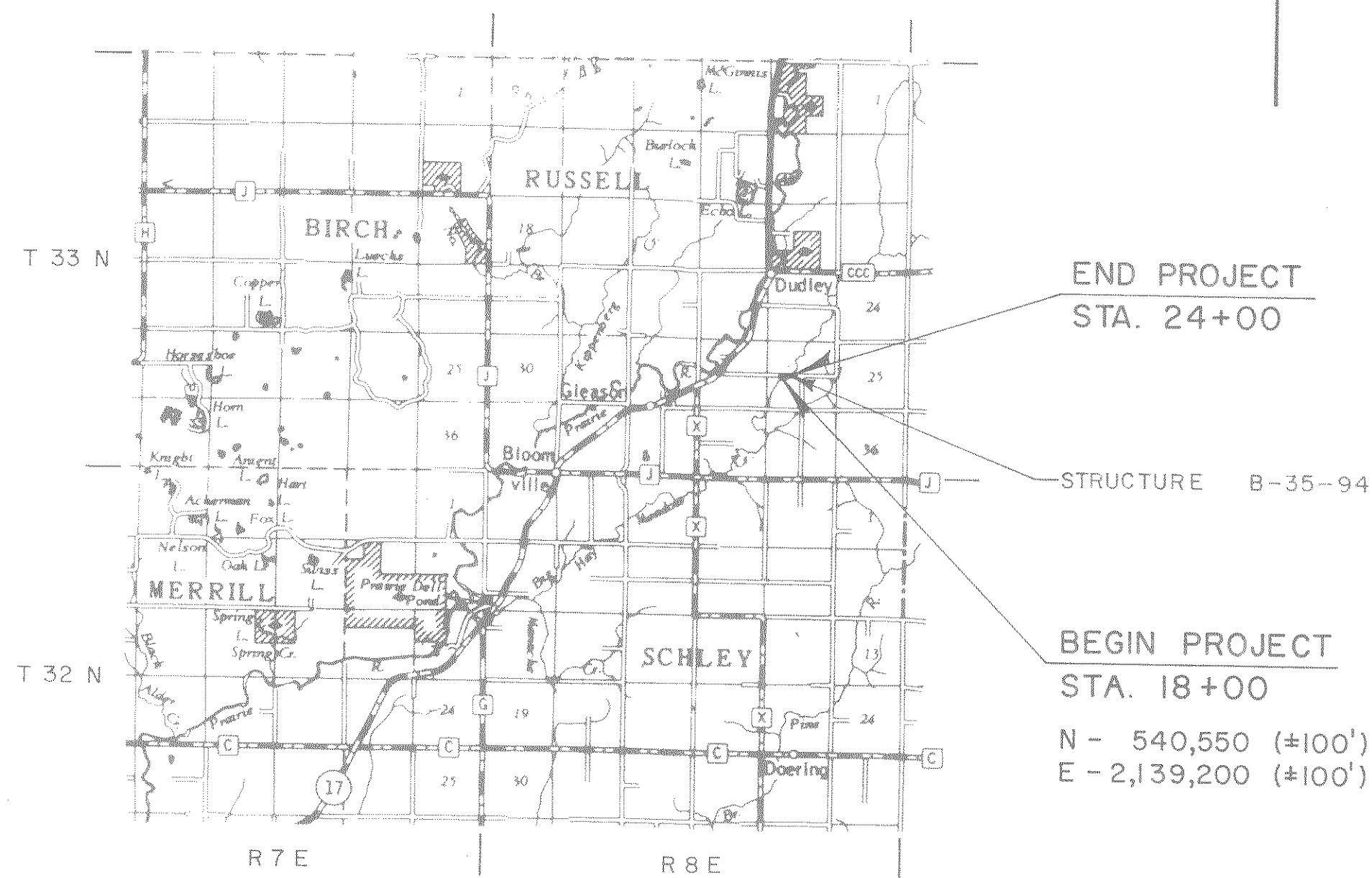
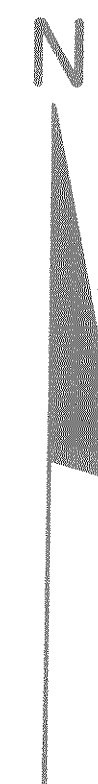
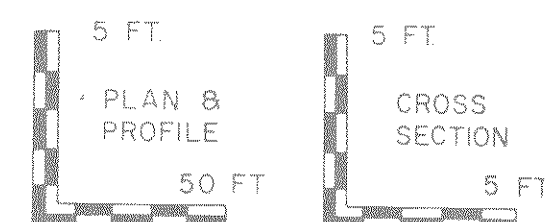

END PROJECT
STA. 24+00

STRUCTURE B-35-94

BEGIN PROJECT
STA. 18+00

N - 540,550 (±100')
E - 2,139,200 (±100')

Layout
Scale 0 1 2 Mi.

Total Net Length of Centerline = 0.114 Mi. Rural

NOTE: ALL COORDINATES SHOWN ON THIS PLAN ARE BASED ON THE WISCONSIN COORDINATE SYSTEM CENTRAL ZONE AND ARE SCALED FROM U.S.G.S. TOPOGRAPHIC MAP, BLOOMVILLE WISCONSIN QUADRANGLE, FOR IDENTIFICATION ONLY.

ELEVATIONS SHOWN ON THIS PLAN ARE REFERENCED TO U.S.C. & G.S. DATUM.

| STATE PROJECT | FEDERAL PROJECT | |
|---------------|-----------------|----------|
| | PROJECT | CONTRACT |
| 9859-03-70 | BRZ 3599(10) | I |
| | | |
| | | |

FILE COPY

FEB 19 1986
DONOHUE & ASSOC., INC.

APPROVED FOR RUSSELL TOWNSHIP

2/19/86 *Baron W. Kain*
Date Chairman

APPROVED FOR LINCOLN COUNTY

2/19/86 *Michael J. Harp*
Date Commissioner

ORIGINAL PLANS
PREPARED BY

Donohue
Engineers & Architects

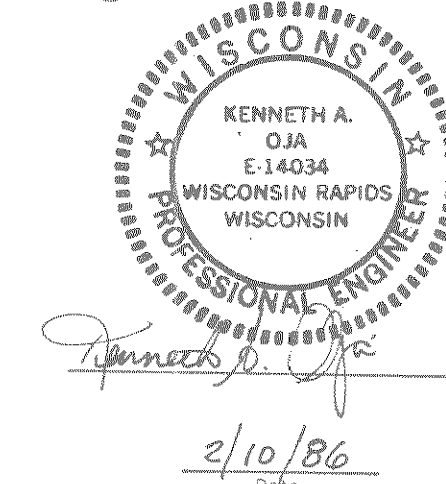

STATE OF WISCONSIN
DEPARTMENT OF TRANSPORTATION

Surveyor Donohue & Assoc., Inc. District Checker D.D.K.
Designer Donohue & Assoc., Inc. C.O. Checker
District Supervisor R.J.S. C.O. Coordinator

Approved: _____
Date _____
District Transportation Director

Approved: _____
Date _____
Chief Design Engineer

Approved: _____
Date _____
Director of Development

U.S. DEPARTMENT OF TRANSPORTATION
FEDERAL HIGHWAY ADMINISTRATION
REGION 5 WISCONSIN DIVISION

Approved: _____
Date _____
Division Administrator

Design Designation

| | |
|---------------|-------------|
| A.D.T. (1986) | = 85 |
| A.D.T. (2006) | = 135 |
| D.H.V. (2006) | = 20 |
| D. | = 50% - 50% |
| T. | = 7% A.D.T. |
| V. | = 40 MPH |

Conventional Signs

| | | | |
|--------------------------------------|--|--|--|
| County Line | | Caution Symbol (Combustible fluids under pressure) | |
| Township or Range Line | | Railroads | |
| Section Line | | Fence | |
| Corporate or City Limits | | Culverts in Place | |
| Property line | | Culverts Required | |
| Lot Line | | Power Pole | |
| Existing Right of Way Line | | Telephone or Telegraph Pole | |
| New Right of Way Line | | Right of Way Markers | |
| Base or Survey Line | | Marsh | |
| Slope Intercept | | Wooded Area | |
| Existing Roadway or Private Entrance | | Grade Elevation | |

FINAL PLANS 2-21-86